

Create a new Stella Epic USB Key

Name brand USB drive 8gb or smaller Install only the 'UNIC' folder on the USB
Must be formatted first.

To format:

[Downloadable Link to Epic vs48 software](#)

1. Install USB to PC and close any pop-up windows that appear.
2. Open a new folder window and locate the installed USB drive on the left menu.
3. Right-click the drive and select 'Format'.
4. Select 'FAT32' under File system and name Volume label *EPIC*.
5. Select 'Start'.
6. Close format window when complete.

Install Sync file:

1. Open the Download link
2. Select 'Download all' from the right of the browser window – file will prepare for download.
3. Select 'Download now' when file becomes available – file size is 21.1mb.
4. Open a new folder window and locate the 'Downloads' file.
5. Right-click the new compressed (ZIP) folder *Epic Software*.
6. Select 'Extract All'.
7. When prompted to select a destination and extract files, select 'Browse' and choose 'Desktop' as the file destination, then select 'Extract'.
8. Double-click new *Epic Software* folder on the desktop.
9. Right-click *UNIC* folder and select 'Copy'.
10. Open a new folder window and locate formatted *EPIC* drive from the left menu.
11. Right-click *EPIC* drive and select Paste.
Place only the UNIC folder on the new USB!

12. Check that *UNIC* folder has loaded to *EPIC* drive – files in *UNIC* folder will display as shown below:

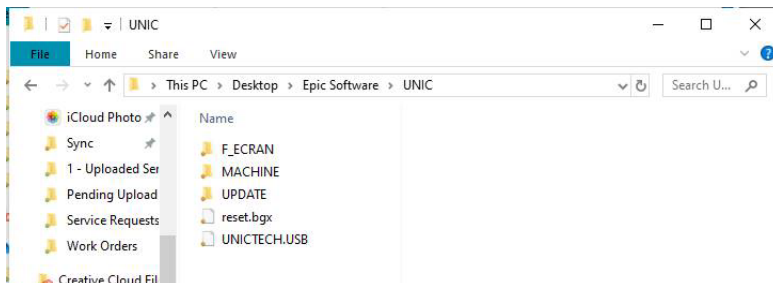

13. Right-click *EPIC V37* drive and choose 'Eject'.
14. Remove USB drive from computer.

◆ Procedure for updating the machine

Note: Leave the USB flash drive in its housing throughout the update procedure.

Insert the USB flash drive, you have several possibilities, update of the CPU, BTA or BGX update.



STAGE 1: introduce the updated USB flash drive. BTA update.



STAGE 2: CPU update

The procedure starts automatically with validation.

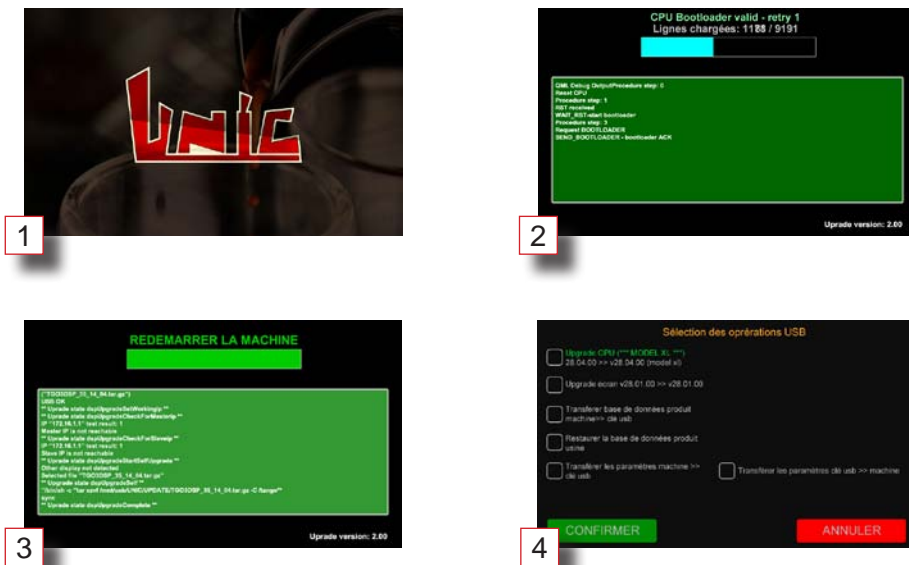

STAGE 3: BGX update

Before updating, check in the CIM that the number of units matches what actually exists. The procedure starts automatically with validation.

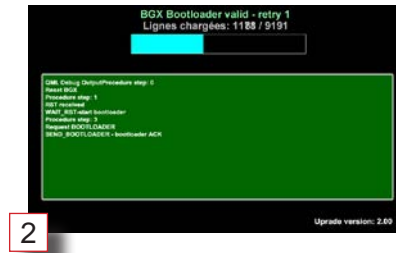

STAGE 4: Export / import products.

